

REV.	ECR	DESCRIPTION	DATE
-	8079	INITIAL DRAWING REQUEST	12/08/08
A	8464	CHANGED PLIT424 TO PLIT425	7/7/2009

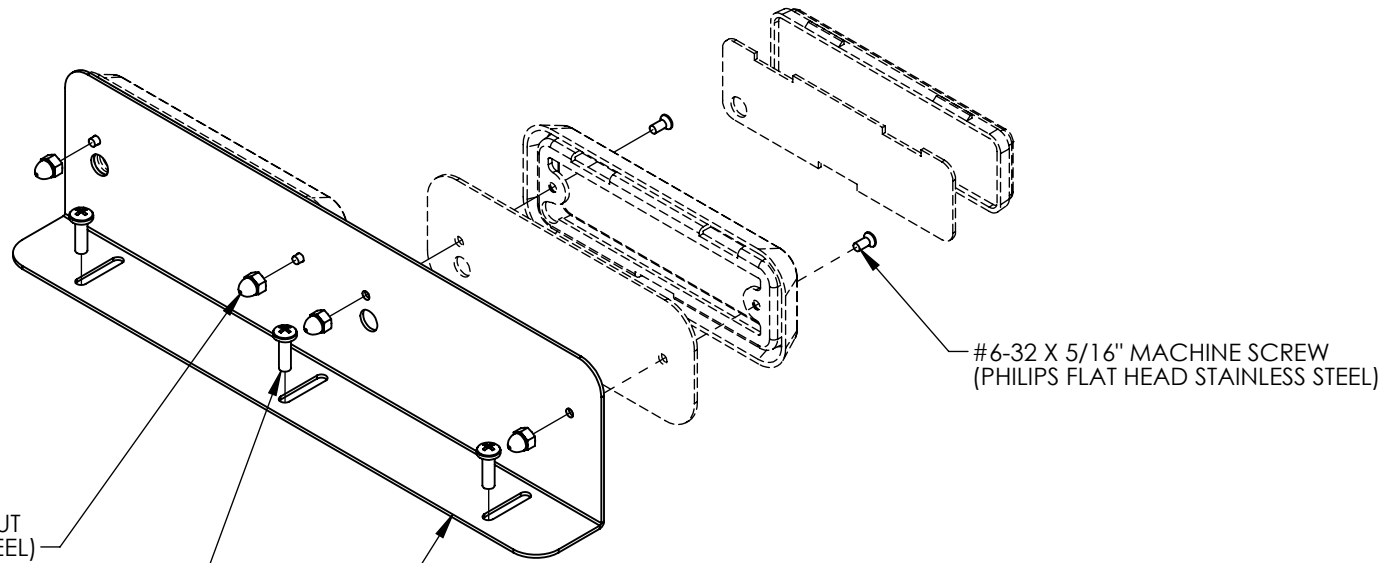

#6 ACORN NUT
(STAINLESS STEEL)

#10 X 5/8 SELF TAP SCREW
(PHILIPS, TYPE 25, STAINLESS)

1X2 BRACKET
(16 GAGE CRS, BLACK POWDER COAT)

#6-32 X 5/16" MACHINE SCREW
(PHILIPS FLAT HEAD STAINLESS STEEL)

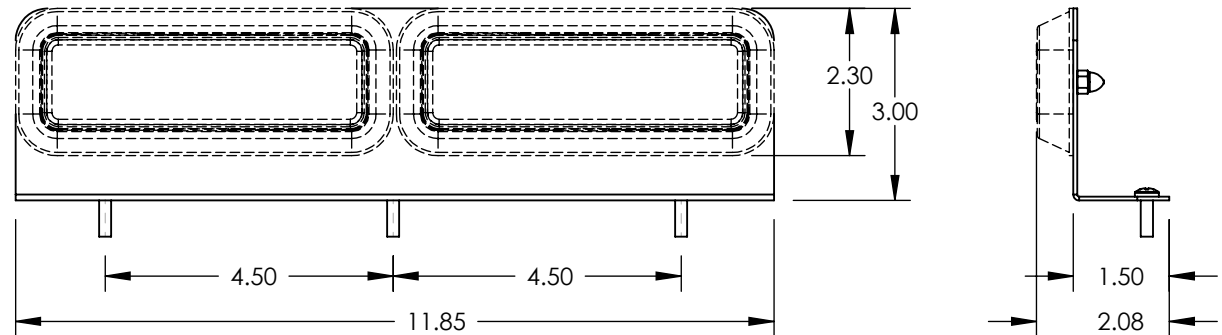

NOTES:

- 1) 10X12 POLY BAG (P30024-17)
- 2) BAG LABEL (PLAB21X2WHI)
- 3) INSTRUCTION SHEET (PLIT425)



UNLESS OTHERWISE SPECIFIED DIMENSIONS ARE IN INCHES TOLERANCES: ANGULAR: ± 2 DEG. .X ± .100 .XX ± .020 .XXX ± .005 .XXXX ± .001	DRAWN BY: MD	STAR HEADLIGHT & LANTERN CO., INC. 455 Rochester St. Avon NY 14414 Ph:(585) 226-9500 Fax: (585) 226-2029
	DRAWING APPROVED BY ECR THE INFORMATION CONTAINED IN THIS DRAWING IS THE SOLE PROPERTY OF STAR HEADLIGHT & LANTERN CO., INC.. ANY REPRODUCTION IN PART OR AS A WHOLE WITHOUT THE WRITTEN PERMISSION OF STAR HEADLIGHT & LANTERN CO., INC. IS STRICTLY PROHIBITED.	
RoHS COMPLIANT: Yes	MODEL: 274-DLXT-1X2	
MATERIAL: N/A	TITLE: 274-DLXT-1X2 MODEL DRAWING	
FINISH: N/A	DWG. NO. 274-DLXT-1X2	REV A
SCALE: 1:3 DO NOT SCALE FROM DRAWING		SHEET 1 OF 1